



EVENT SPACES IN PAVILLON 36

DEUTSCHE MESSE TECHNOLOGY ACADEMY





PAVILLON 36 - A UNIQUE LOCATION

- atmosphere of a high-tech factory
- good (public) transport connections
- free parking spaces
- spacious reception area
(with counters, welcome screen and checkroom)
- daylight-flooded conference rooms
- modern event technology
- offers space for up to 200 people
- offers the possibility to hold conferences with workshops or break-outs through 10 flexible rooms



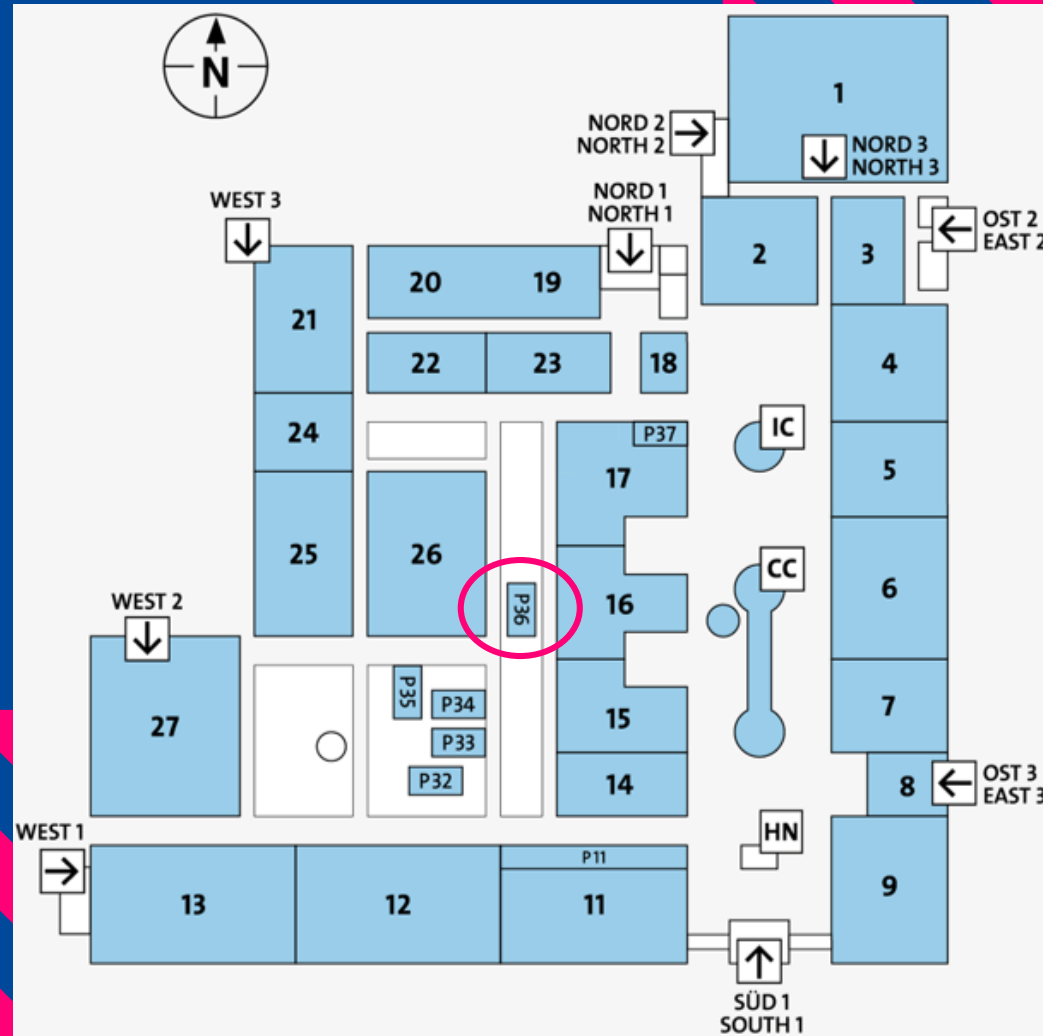

Fairground Pavillon 36

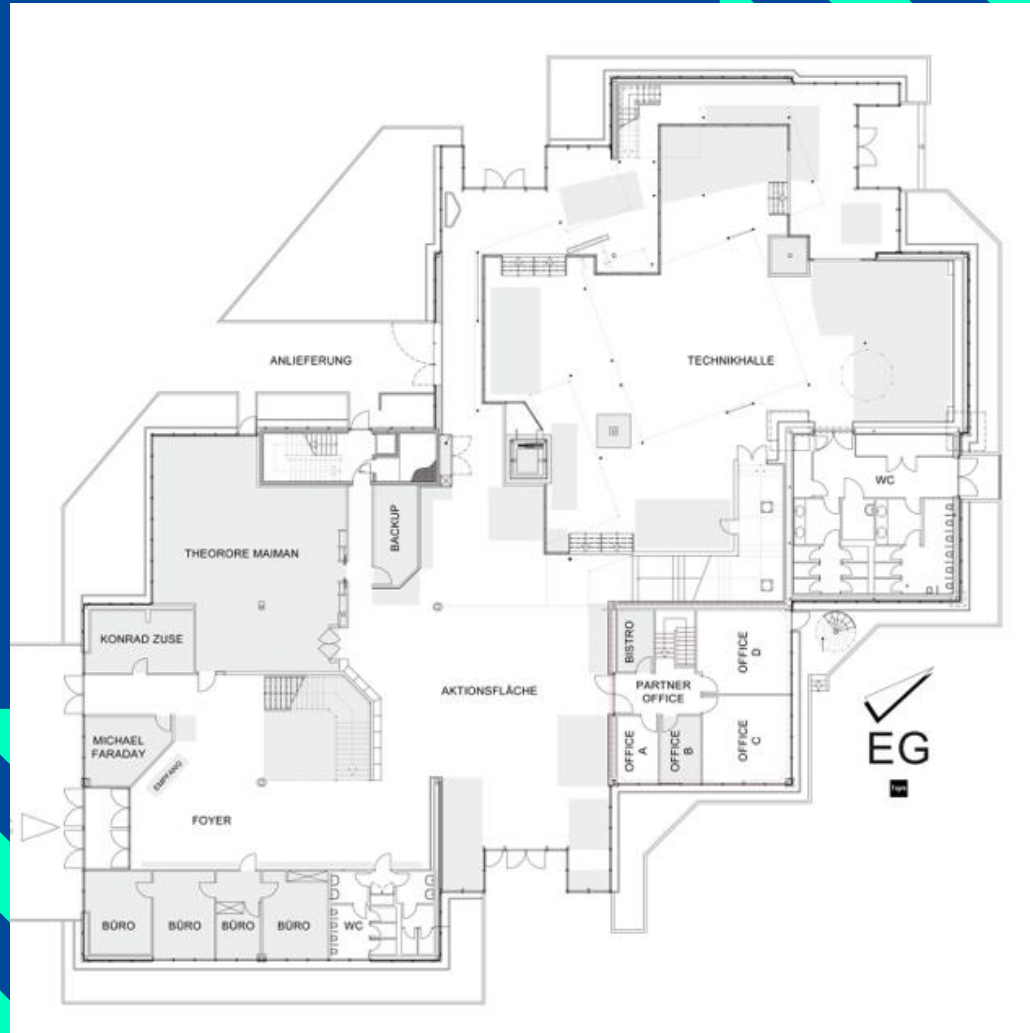

Pavillon 36 Ground floor plan

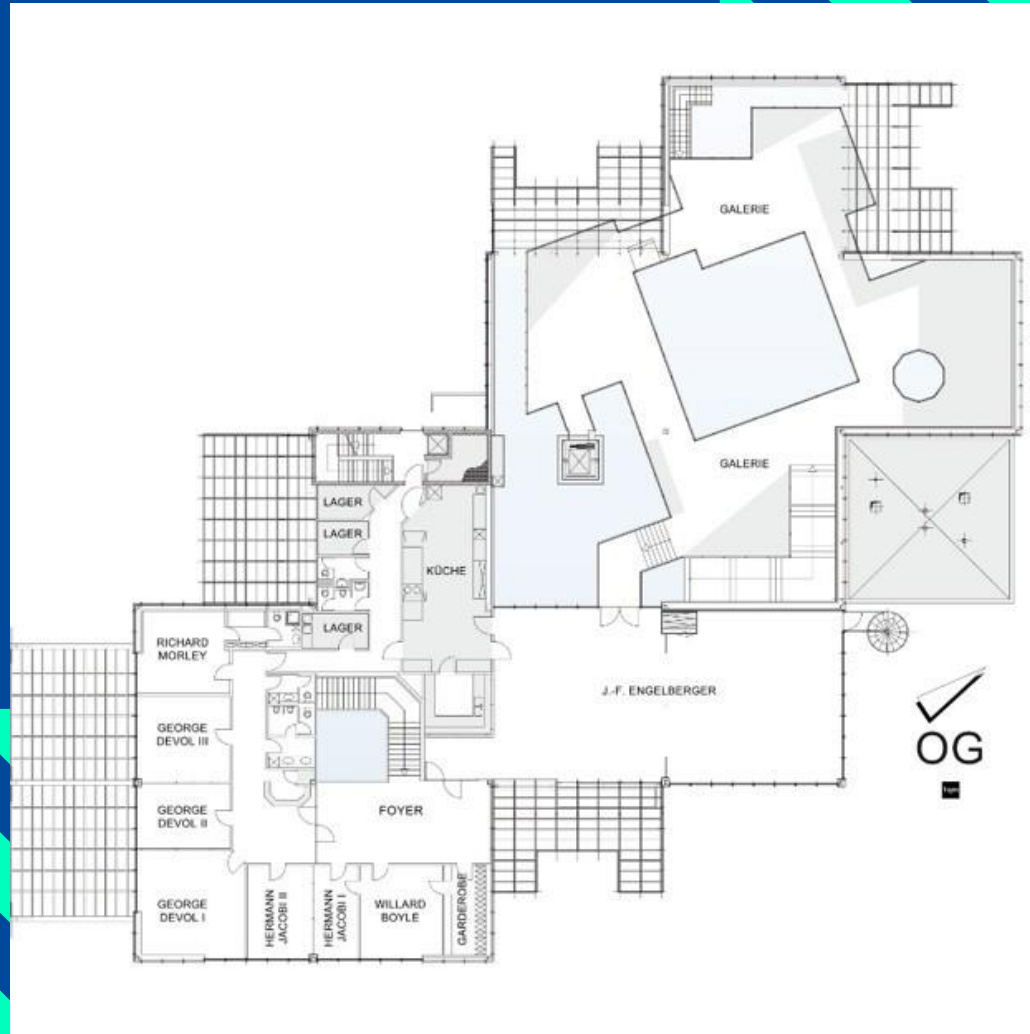

Pavillon 36 Upper floor plan



PAVILLON 36 - ROOM CAPACITIES GROUND FLOOR

	M ²	Theatre-style	Classroomstyle	U-Shape	Square-style	Cocktail
Technikhalle		130*	50	40	44	110
Technikhalle inkl. Galerie		200*	60	-	-	200
Aktionsfläche	160	-	-	-	-	150

* quantity depends on the size of the stage (the stage is installed separately)

PAVILLON 36 - ROOM CAPACITIES UPPER FLOOR

	M ²	Theatre-style	Classroomstyle	U-Shape	Square-style	Cocktail
Joseph F. Engelberger	195	165	90	40	44	150
Richard Morley	22	-	-	10	10	-
Hermann Jacobi I	13	-	-	-	6	-
Hermann Jacobi II	20	-	-	-	10	-
Hermann Jacobi I-II	33	20	12	12	16	15
George Devol I	35	20	8	14	18	15
George Devol II	20	-	-	8	10	-
George Devol III	26	12	-	10	14	-
George Devol I-II	55	30	16	20	24	40
George Devol II-III	46	18	12	18	20	20
George Devol I-III	81	40	24	34	36	70
Willard Boyle	25	15	-	9	12	-



Deutsche Messe
Technology Academy

IMPRESSIONS



Event your business.



FOYER (GF)

- Spacious reception area (100 m²)
- Reception counter
- Welcome Screen
- Wardrobe



AKTIONSFLÄCHE (GF)

- Spacious catering area (160 m²) for up to 150 people
- Suitable for standing and seated receptions
- Ideal for exhibitor and sponsor presentations
- Robots and automation technology are presented in showrooms



TECHNIKHALLE (GF)

- Up to 130 persons
- In combination with the gallery up to 200 persons
- Innovative event format, practice and theory in one place
- Robots and automation technology are presented in showrooms
- All installed technology can be included in fully functional events
- Participants can watch presentations in changing showrooms
- Conference technology: high-performance beamer, screen (can be booked separately)
- Suitable for technical presentations, panel discussions talks, etc.



GALERIE (UF)

- Direct view on the Technikhalle
- Seating for up to 70 people
- Suitable for workshops, brainstorming sessions, catering, etc.
- Automation technology is presented in showrooms
- Accessible by stairs or elevator
- Direct access to the J. -F. Engelberger



J. –F. ENGELBERGER (UF)

- Up to 165 people
- Conference room with daylight, glazing with sunshade illumination
- Infinitely variable lighting
- Free Wi-Fi
- Conference technology: high-performance projector, screen, sound system (can be booked separately)
- With variable partition wall



WILLARD BOYLE (UF)

- Small conference room up to 10 persons with daylight, fully darkenable
- Free Wi-Fi
- Conference equipment: presentation monitor, flipchart, pin board, presentation case etc. (can be booked additionally)



HERMANN JACOBI I-II (UF)

- Small conference room up to 16 persons with daylight, fully darkenable
- Free Wi-Fi
- Conference equipment: presentation monitor, flipchart, pin board, presentation case etc. (can be booked additionally)
- With variable partition wall



GEORGE DEVOL I–III (UF)

- Three modular conference rooms for 3 to 30 persons with daylight, fully darkenable
- Free Wi-Fi
- Conference equipment: beamer, projection screen, flipchart, pin board, presentation case etc. (can be booked additionally)



RICHARD MORLEY (UF)

- Small conference room up to 10 persons with daylight, fully darkenable
- Free Wi-Fi
- Conference equipment: presentation monitor, flipchart, pin board, presentation case etc. (can be booked additionally)





WHAT WE OFFER

- Total event area of 2500qm over two levels with flexible design options for up to 300 people - from meeting rooms to congress halls
- Pavilion 36 is located in the middle of the world's largest exhibition center and has a spacious park, which you are welcome to use for a barbecue or similar in the warm season.





Deutsche Messe
Technology Academy

ANY QUESTIONS?

MILLEKE BERNSTEIN

Director Event & Marketing Management

Tel.: +49 511 89 35404

Mobil: + 49 175 2201862

Mail: milleke.bernstein@messe.de



Event your business.