

Robotation Academy Metropolitan Academy

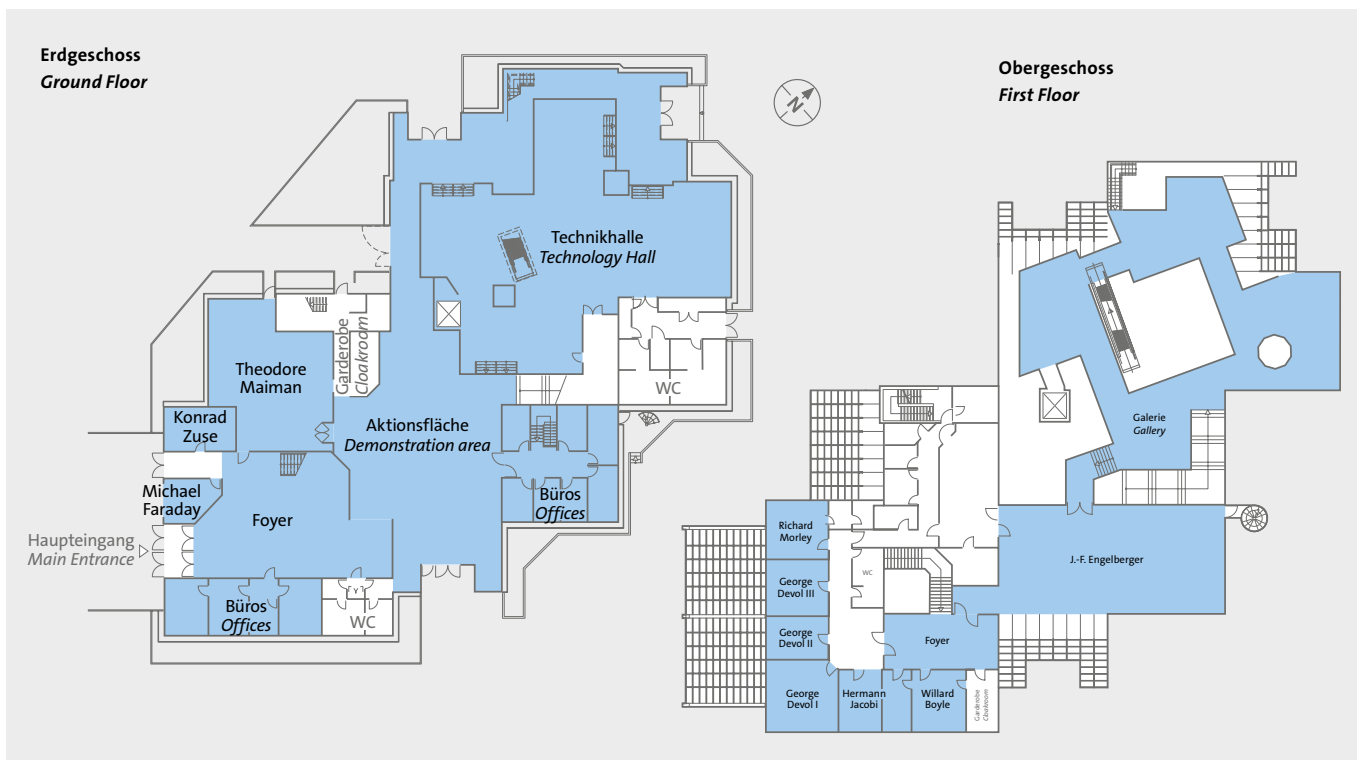

Erdgeschoss / Ground Floor			
Raum / Room	Geschoss / Floor	m ²	Personen / Capacity
Konrad Zuse	EG / Gr. Floor	35	10
Michael Faraday	EG / Gr. Floor	20	5
Cafeteria / Cafeteria	EG / Gr. Floor	120	50
Theodore Maiman Stuhlreihe - 40 P. Parlamentarisch – 20 P. Theatre-style seating 40 pers. Parliamentary-style seating 20 pers.	EG / Gr. Floor	90	
Technikhalle inkl. Galerie Stehempfang – 150 P. (mit Galerie – 200 P.) Theaterbestuhlung – 110 P.* (mit Galerie – 150 P.) Parlamentarisch – 50 P. (mit Galerie – 60 P.) Technology Hall, incl. gallery Reception standing – 150 pers. (with gallery 200 pers.) Theatre-style seating – 110 pers.* (with gallery 150 pers.) Parliamentary-style seating – 90 pers. (with gallery 60 pers.)	EG / Gr. Floor	250	200
Foyer	EG / Gr. Floor	100	50
Aktionsfläche/Demonstration area	EG / Gr. Floor	90	100
Büros/Offices	EG / Gr. Floor	140	30

Obergeschoss / First Floor			
Raum / Room	Geschoss / Floor	m ²	Personen / Capacity
Joseph F. Engelberger Stehempfang – 150 P. Theaterbestuhlung – 165 P. Parlamentarisch – 90 P. Reception standing – 150 pers. Theatre-style seating – 100 pers. Parliamentary-style seating 90 pers.	OG / 1st Floor	195	150
Richard Morley	OG / 1st Floor	22	14
George Devol I	OG / 1st Floor	35	18
George Devol II	OG / 1st Floor	20	10
George Devol III	OG / 1st Floor	26	14
Hermann Jacobi I	OG / 1st Floor	20	6
Hermann Jacobi II	OG / 1st Floor	13	14
Willard Boyle	OG / 1st Floor	25	12
Academy komplett Academy complete	OG/KG/EG 1st Floor/Basement/ Ground Floor	2.500	300

* Menge ist abhängig von der Bühnengröße (die Bühne wird extra eingebaut)
* Numbers depend on stage size (stage is built as per briefing)

Weitere Informationen und Ansprechpartner finden Sie unter www.robotation.de / For details and persons to contact, visit www.robotation.de